

⚠

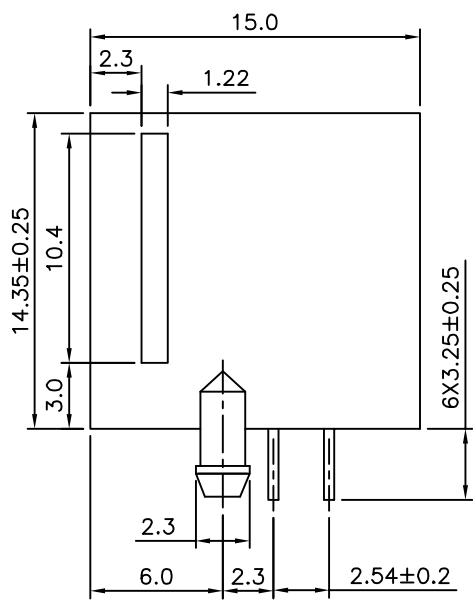

⚠

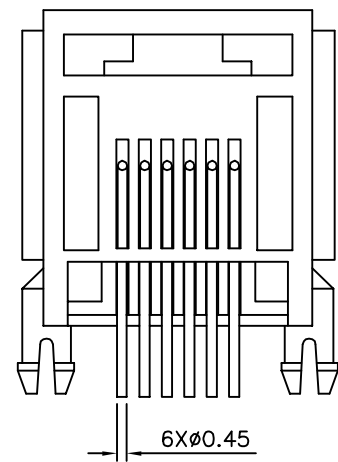

⚠

**△ SPECIFICATION**  
 Housing:PBT+G.F.(UL94V-0),Gray  
 Contacts:Phosphor Bronze  
 Gold Plated 6u" Over All,Over Nickel  
 Cavity Confirms To FCC Rules And Regulations  
 Part 68,Subpart F.  
 RoHS Compliant

**RJ11 RJ12 6P6C Gray Telephone Socket for Landline**

<https://www.sunrom.com/m/6248>

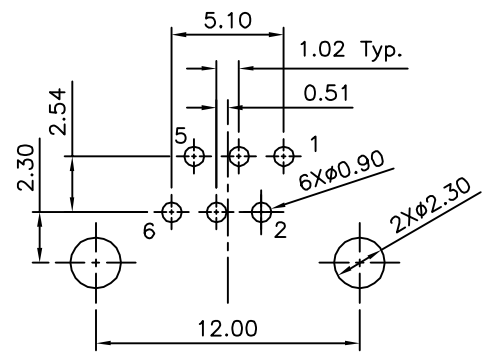

⚠ Recommended P.C.B. Layout(Top View)  
 Recommended P.C.B. Thickness:1.6mm  
 Tolerance:±0.05

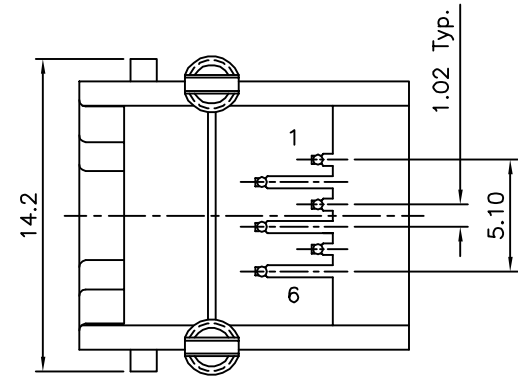

⚠

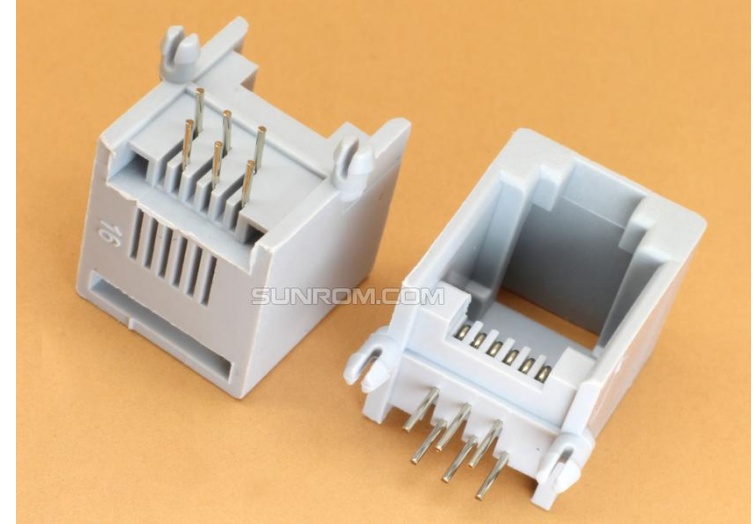

DRAWING No.		APPROVED BY		UNLESS OTHERWISE SPECIFIED TOLERANCES ARE △△ .X ±0.25 .XX ±0.13 .XXX ±0.05					
6248		MEI			△ A2	Modify Data	HZF	05/23/2013	
		HZF			△ A1	Modify Data	HZF	04/08/2011	
		DRAWING BY		SONG		△ A0		NEW RELEASE	
SCALE	NONE	REV.	A2	UNIT	mm	NO.REV.	REVISIONS	CHK	DATE